

- 3.3-6** The tension member shown in Figure P3.3-6 is a $C12 \times 20.7$ of A572 Grade 50 steel. Will it safely support a service dead load of 60 kips and a service live load of 125 kips? Use Equation 3.1 for U .
- Use LRFD.
 - Use ASD.

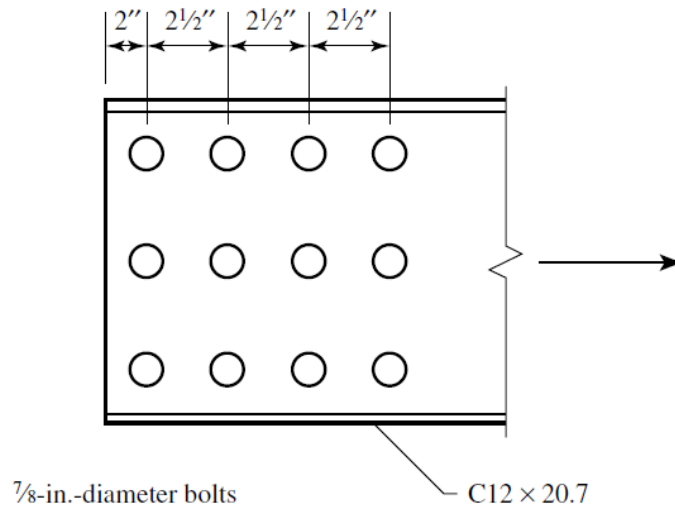

FIGURE P3.3-6

- 3.4-5** The tension member shown in Figure P3.4-5 is an $L6 \times 3\frac{1}{2} \times \frac{5}{16}$. The bolts are $\frac{3}{4}$ inch in diameter. If A36 steel is used, is the member adequate for a service dead load of 31 kips and a service live load of 31 kips?
- Use LRFD.
 - Use ASD.

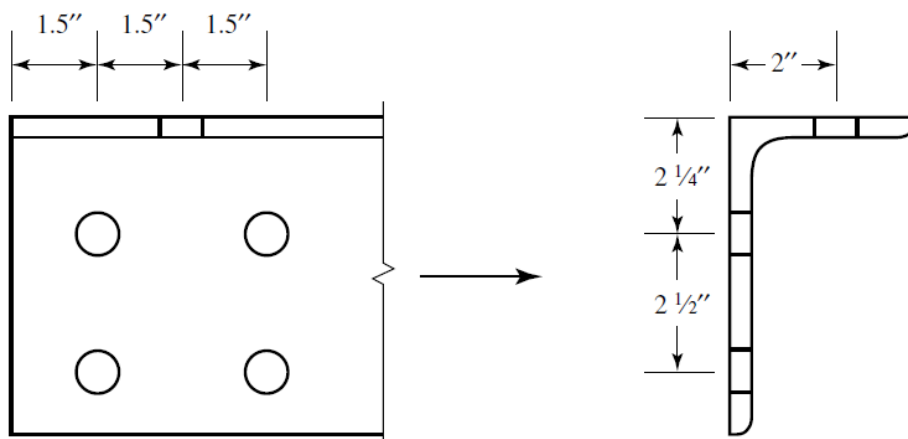

FIGURE P3.4-5