



Projection Drawing:

It is the view seen from a specific direction by flattening the objects and clarifying their three dimensions. The projection of a shape is created by imagining seeing it from different directions and drawing it on different levels:

- .1 Vertical level: In which the object is seen from the front
- .2 Horizontal level: In which the object is seen from above
- .3 Lateral level: In which the object is seen from the side

The process of creating projections depends on the visual imagination ability for different viewing angles. For example:

Orthographic and isometric projections of an object

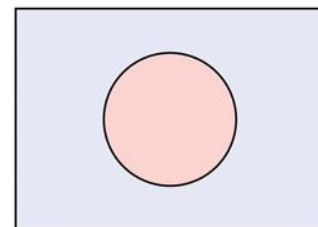

top view

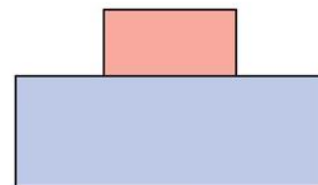

front view

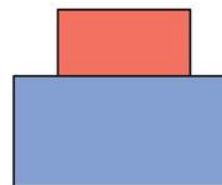

side view

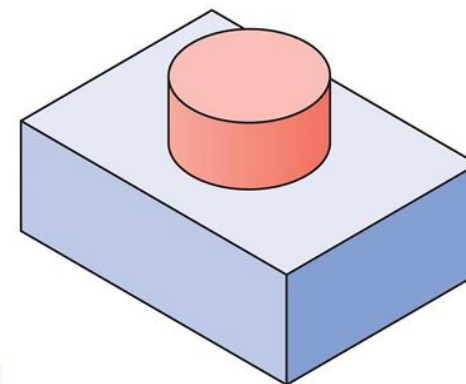

3-dimensional isometric projection

2-dimensional orthographic projection





Al-Mustaqbal University
Department (Communications Engineering)
Class (1ST class)
Subject (Engineering drawing) / Code (UOMU028014)
Lecturer (Doaa Hazim Aziz)
1st/2nd term – Lect. (Projection Drawing)

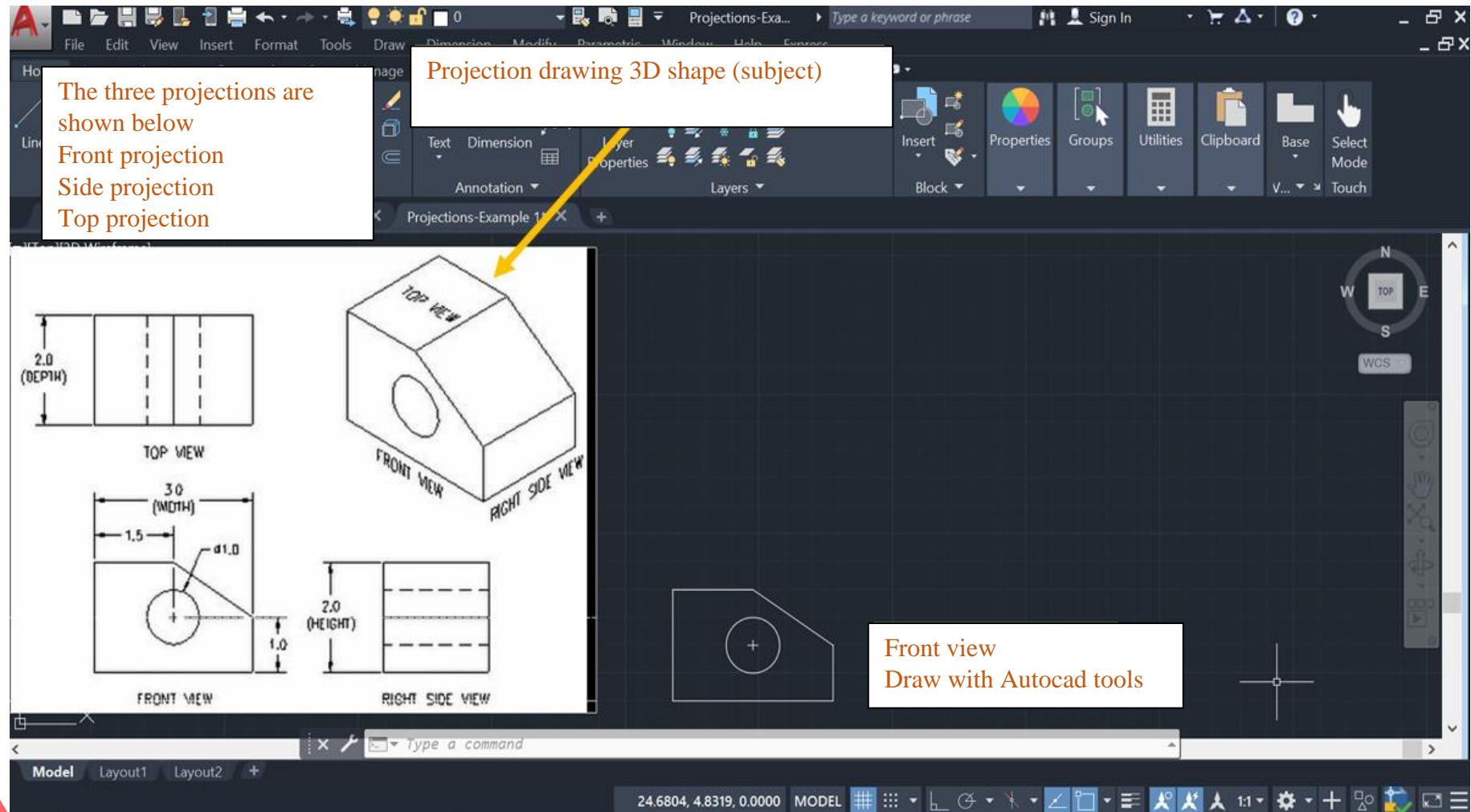



Al-Mustaqbal University
Department (Communications Engineering)
Class (1ST class)
Subject (Engineering drawing) / Code (UOMU028014)
Lecturer (Doaa Hazim Aziz)
1st/2nd term – Lect. (Projection Drawing)

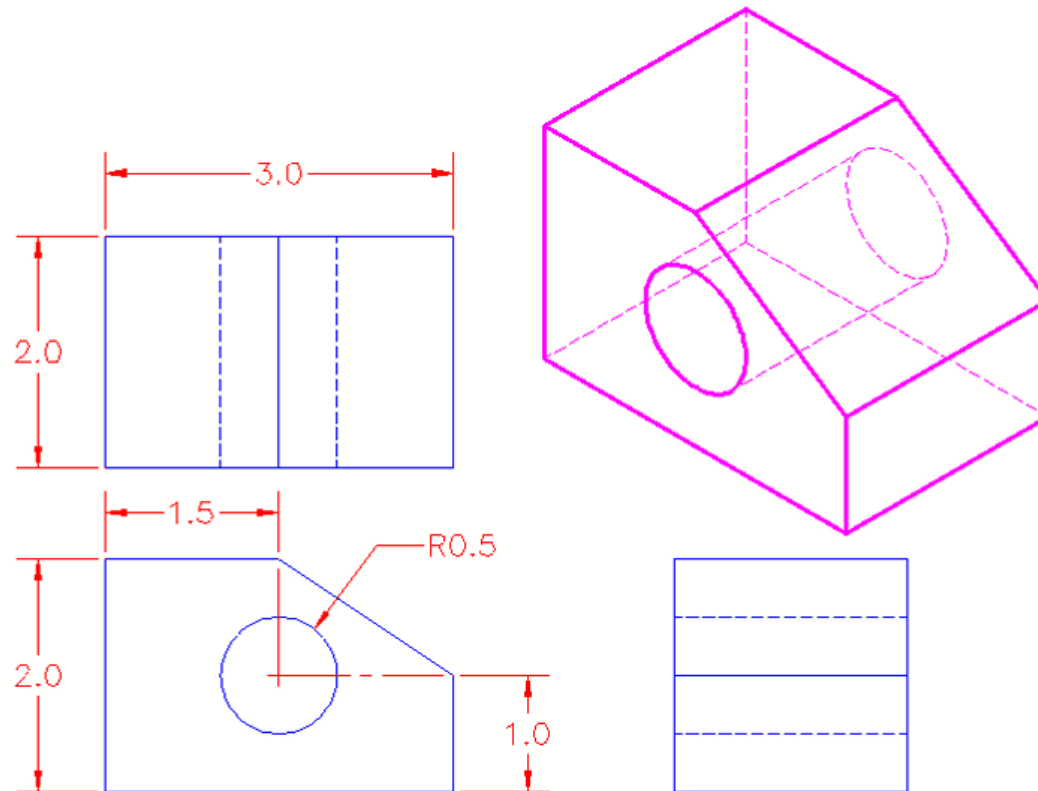



Al-Mustaqbal University
Department (Communications Engineering)
Class (1ST class)
Subject (Engineering drawing) / Code (UOMU028014)
Lecturer (Doaa Hazim Aziz)
1st/2nd term – Lect. (Projection Drawing)

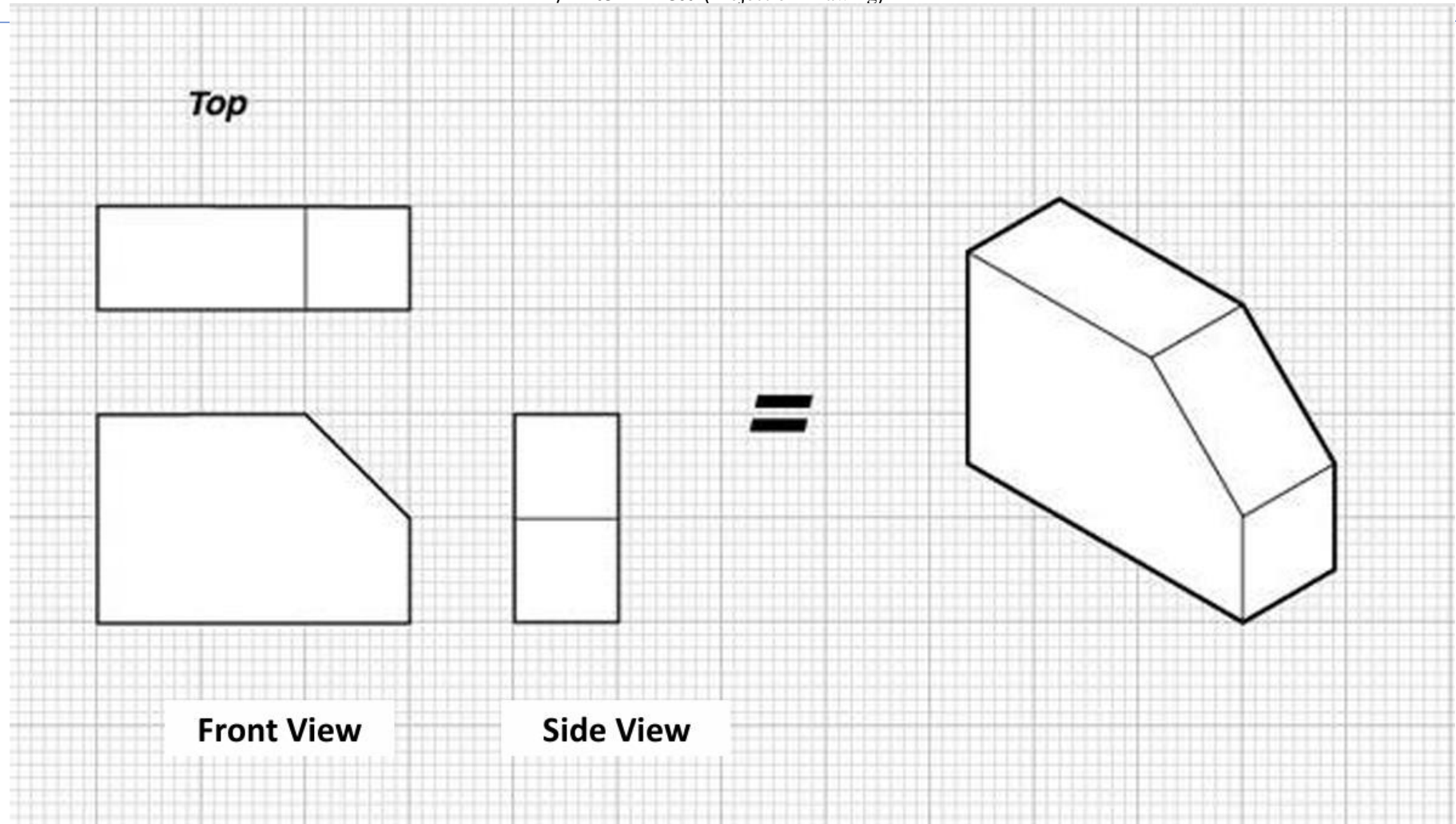



Pictorial Representation

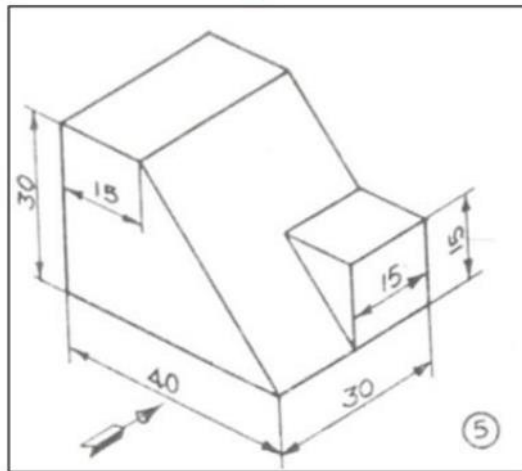

Orthographic Projection (1 Angle)

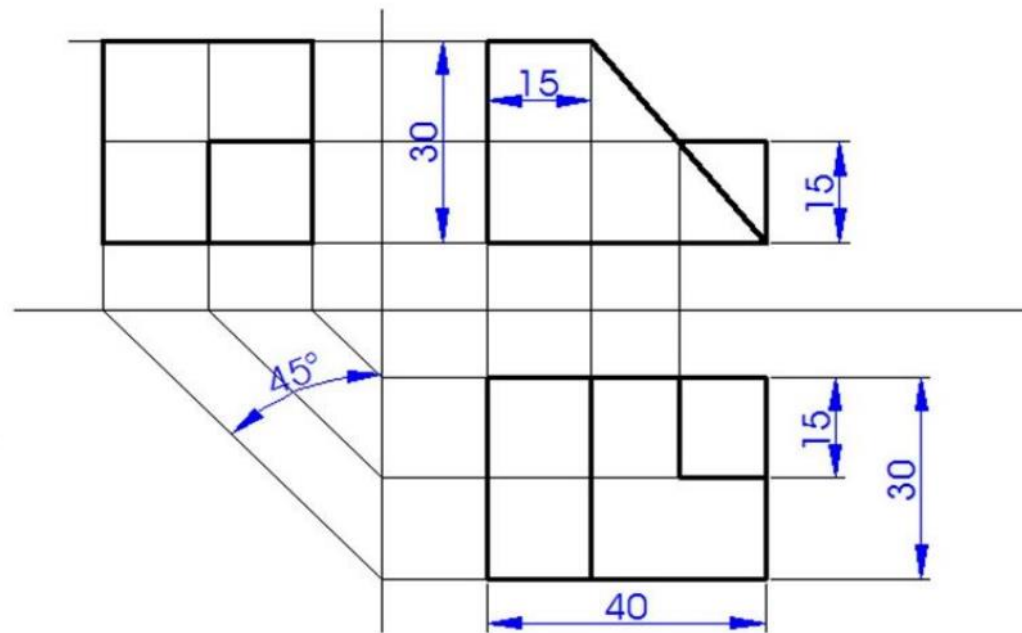

Problem 1



